

Please follow these fixing and care instructions to ensure that your product is fitted safely and that it retains its high quality finish. Please retain this leaflet for future reference.

This instruction leaflet applies to the following products;

DG400141 - Pop Up Basin Plug Converta

Fixing Pack/Contents

- A. Expanding Insert x1
- B. Hex Key x1
- C. Hex Key Handle x1
- D. Converta Plug x1
- E. Black Ring (Large) x1
- F. Blue Ring (Medium) x1
- G. Green Ring (Small) x1

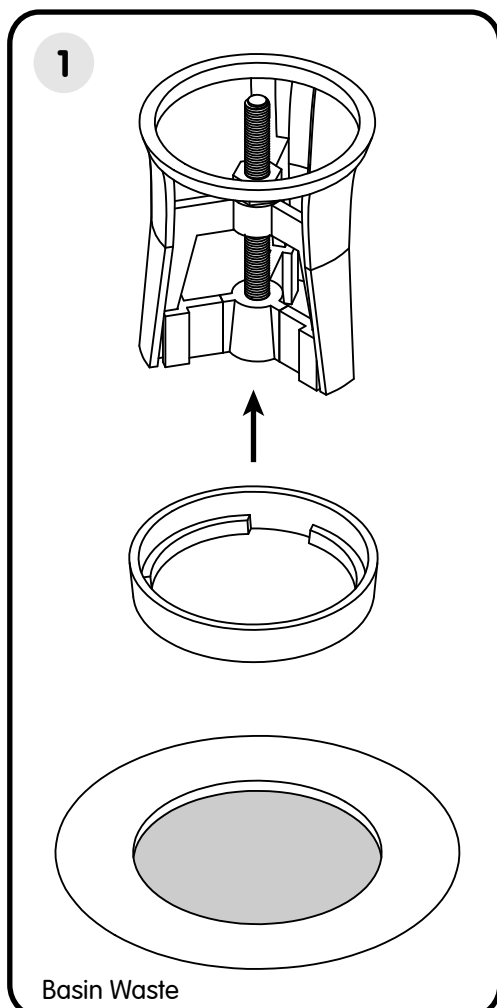
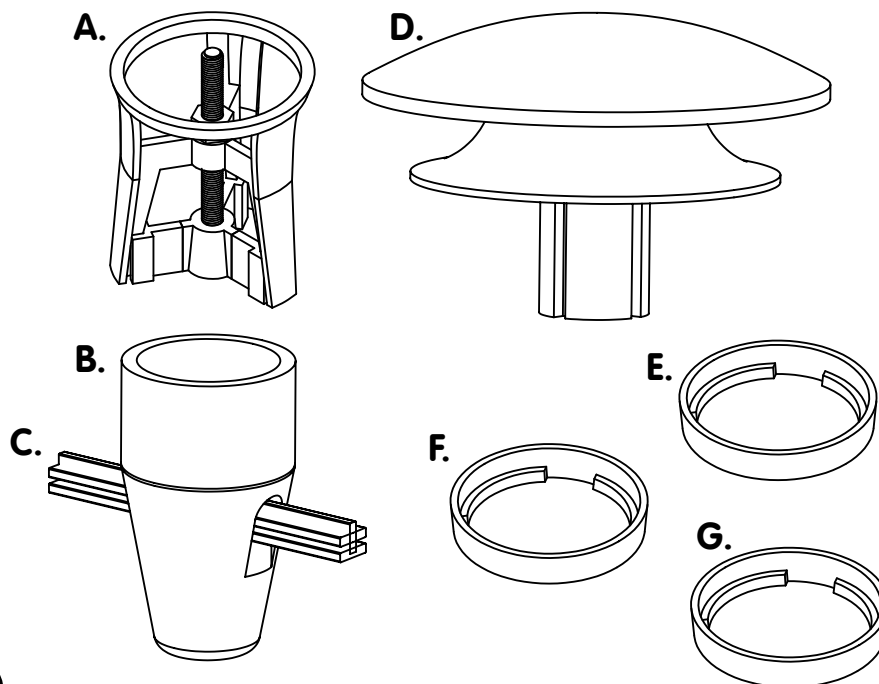

1. The first step is to find which Ring suits your basin waste. We recommend you try the Black Ring first and then work down to blue and then green. This will reduce the risk of dropping the Expanding Insert down the waste.

The ideal installation will see the expanding plug sitting 1mm inside of the basin drain.

2. Insert the Hex Key Handle into the Hex Key ensuring that the Handle is in the correct orientation.

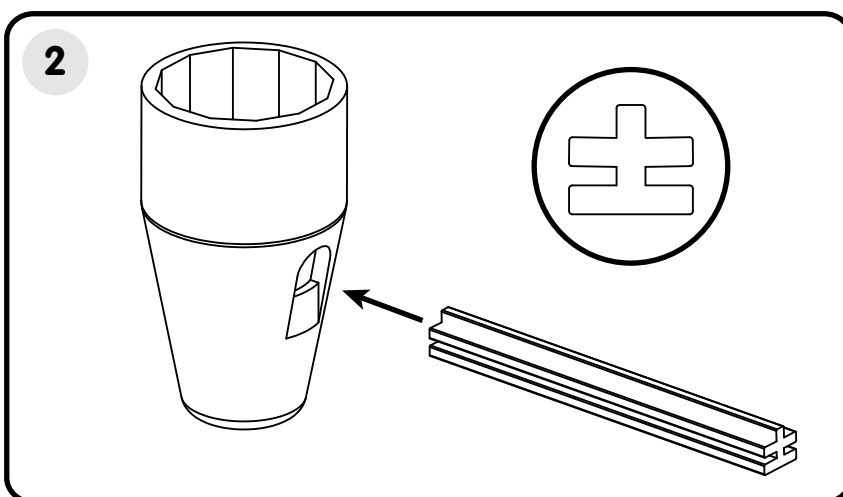

3

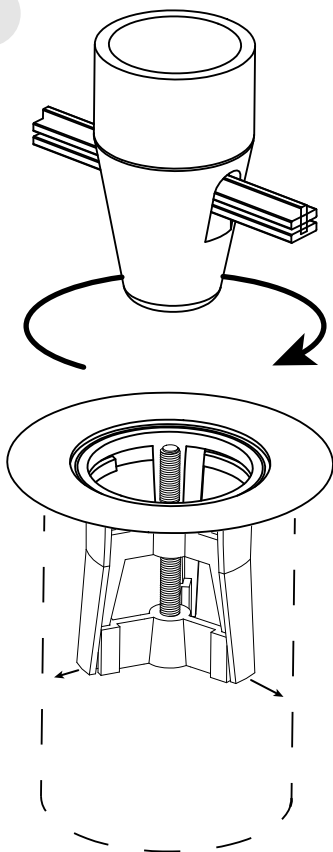

3. Place the Expanding Insert into the basin waste and use the Hex Key and Handle assembly to tighten the nut on the Expanding Insert. Rotating the Key clockwise with push the legs of the Expanding Insert outwards so that it gains a firm hold against the waste.

You should be able to hear the friction between the Expanding Insert and the waste. This is the sign to tell you that the Insert is tight enough. **DO NOT OVERTIGHTEN.**

4

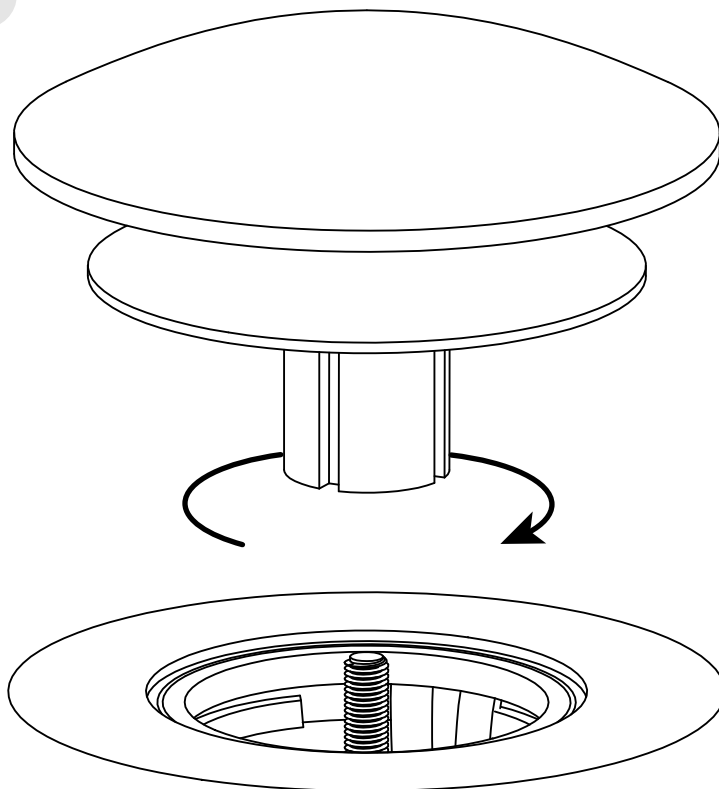

4. Fully screw the Converta Plug onto the Expanding Insert. Click the plug a few times to test if the spring is working. Then fill up your basin and test if the plug is working effectively.

Note

If the plug doesn't seal you may have to screw the Expanding Insert further using the Hex Key. If the plug doesn't release the water you can either loosen the Expanding Insert or unscrew the Converta plug slightly.

Cleaning

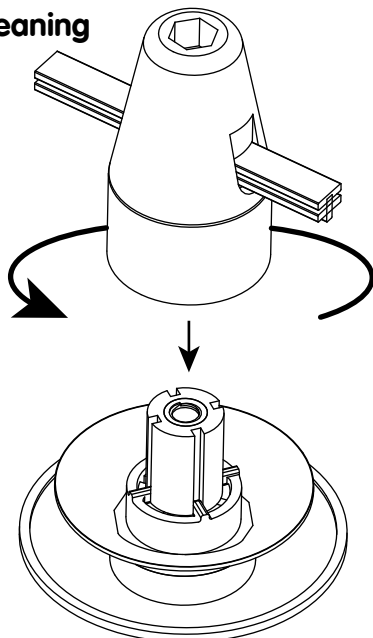

Cleaning. We advise that you clean your plug regularly to avoid any substance obstructing the waste. To do this simply unscrew the plug and clean any debris.

To fully clean the product, use the Hex Key as illustrated to open the spring mechanism. **Be Careful** when opening the Converta Plug as the spring might be in tension. Keep all parts in position when cleaning to avoid damaging or losing the components.

For details of the other items in the Croydex range please visit our website: www.croydex.com

Croydex, Central Way, Andover, Hampshire,
SP10 5AW, UK

Tel: +44 (0) 1264 365881 Fax: +44 (0) 1264 356437

E-mail: info@croydex.co.uk

S&H 057 R01